

# COVANA

## OASIS

**Read this manual before operating the Covana**



# User Manual

[www.covana.dk](http://www.covana.dk)

COVANA.DK

**⚠ WARNING**

**RISK OF ELECTROCUTION**

ALL ELECTRICAL WIRING MUST BE DONE BY A QUALIFIED PROFESSIONAL.  
THE WIRING MUST MEET THE REQUIREMENTS OF ANY LOCAL CODES AND REGULATIONS.

**⚠ WARNING**

**RISK OF ELECTROCUTION**

THE COVANA OPERATOR MUST BE CONNECTED TO A DEDICATED GFCI  
(GROUND FAULT CIRCUIT INTERRUPTERS) PROTECTED CIRCUIT.  
REFERENCE: MUST COMPLY WITH ALL LOCAL CODES AND REGULATIONS.

**⚠ WARNING**

**RISK OF INJURY**

DISCONNECT OR TURN OFF ALL POWER SUPPLY BEFORE STARTING  
INTERVENTION ON THE COVANA.

**⚠ WARNING**

**RISK OF INJURY**

DO NOT OPERATE THE COVANA WHILE IN WATER.



**⚠ WARNING**

**AVOID DROWNING RISK – ENTRAPMENT POSSIBLE.**

FAILURE TO FOLLOW ALL INSTRUCTIONS MAY RESULT IN INJURY OR DROWNING.  
INSPECT COVER PERIODICALLY.  
POWER SAFETY COVER MEETING ASTM F1346-91 REQUIREMENTS.

# IMPORTANT

ANY MODIFICATION TO THIS PRODUCT WILL VOID THE WARRANTY.

# NOTICE

DO NOT STEP ON THE COVANA OPERATOR.

# NOTICE

REMOVE THE CONTROL KEY AFTER OPERATING THE COVANA.  
STORE THE KEY IN A SECURE LOCATION WHEN NOT IN USE.  
BRING KEY WITH YOU IN THE SPA TO PREVENT UNAUTHORIZED OPERATION OF THE COVANA.

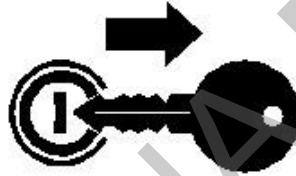

# NOTICE

The key switch must be permanently mounted and located 5 feet (1.5 m) away from the spa and 5 feet (1.5 m) above the deck. User must have full view of the Covana when operating.

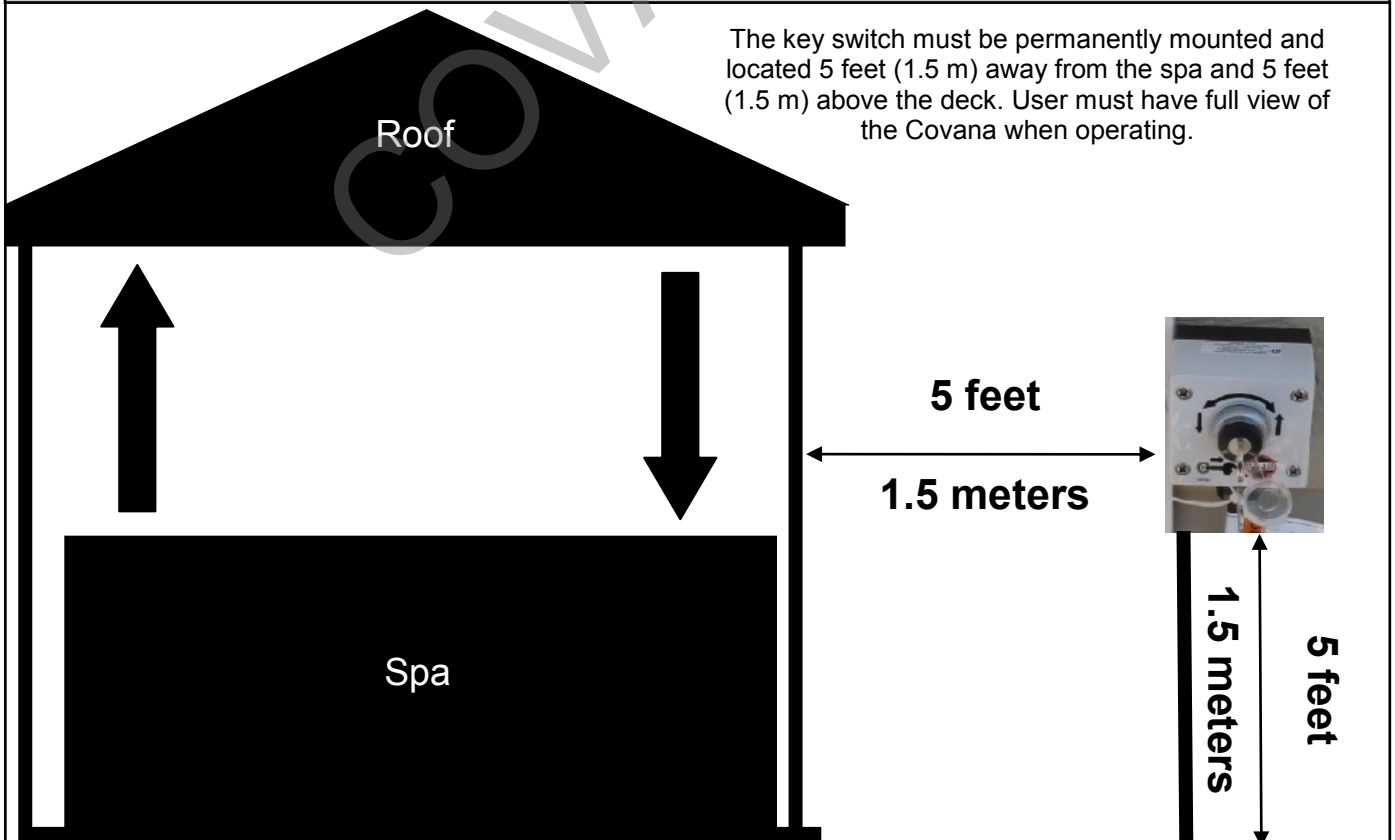

## OPERATING INSTRUCTIONS

1. Be sure all debris and snow is removed from the roof of the Covana before operating.
2. Ensure there are no persons in the spa or near the spa.
3. Ensure there are no obstructions in the way.
4. The key must be held in the proper position until fully opened/closed.
5. The Covana will automatically stop in both the fully opened and fully closed modes.
6. Turn the key clockwise to raise the roof.
7. Turn the key counterclockwise to lower the roof.
8. Key will automatically return to center/off position when released.
9. Remove key when finished operating the Covana.



## MAINTENANCE AND CARE

**Roof** - Wash only with mild detergent or soap and water.

### Lift System

1. The internal jacks will require yearly greasing, early fall is the best time. Use of "Loctite ViperLube High Performance Synthetic Grease" recommended.
  - a. Lower the roof until it is fully closed.
  - b. Remove the five screws on the top plate of **EACH** post.
  - c. Turn the key to activate the system.
  - d. The four internal jacks will start to elevate but the roof will stay lowered on the spa.
  - e. Elevate the jacks until the system stops on its own.
  - f. Spray grease on all of the sliding and mechanical components.
  - g. Cycle the system up and down a couple times and inspect if any further grease should be applied.
  - h. Lower the system and reinsert the screws using a hand screwdriver as a power tool may break the screws.
2. The operator will require yearly greasing of its mechanical components.
  - a. Disconnect or turn off the power.
  - b. Remove the four screws on the operator cover.
  - c. Remove the operator cover.
  - d. Spray grease on all the mechanical components.
  - e. Replace the operator cover and reconnect power.

## **WARNING**

**RISK OF INJURY**  
DISCONNECT OR TURN OFF ALL POWER SUPPLY BEFORE STARTING  
INTERVENTION ON THE COVANA OPERATOR.

# TROUBLESHOOTING

PROBLEM	CAUSE	SOLUTION
<p>The Covana will not elevate or lower</p> <ul style="list-style-type: none"> <li>• motor is silent</li> <li>• no visible movement</li> </ul>	No power	Check GFCI and reset if tripped.
		Check breaker panel.
		Check key switch – open the key switch and review connections – might need retightening.
		Motor overheated – wait 30 minutes and try again.
		Review electrical troubleshooting guide.
		Review operator’s manual for the procedure to operate the Covana manually.
		Consult Electrician.
<p>The Covana will not elevate or lower</p> <ul style="list-style-type: none"> <li>• motor is humming</li> <li>• some visible movement</li> </ul>	Posts are frozen	Remove all snow and ice from Covana roof and release all shades/screens from lower restraining brackets.
		Turn key off and on a number of times to free up frozen post.
		Slap the side of each post to free up the system and to break loose any ice/frost.
		Spray a silicone base lubricant on the telescoping aluminum sleeves.
		Ensure proper seal – turn on all the jets and air, lower roof, detect any leakage in the area of the posts. If leakage is occurring, loosen the outside post clamp and push down on the roof until leakage stops and retighten clamp and reinsert safety screw.
		Perform the jack greasing procedure.
	Mechanical issue	Call your dealer.
<p>Shades or screens</p> <ul style="list-style-type: none"> <li>• Too loose</li> <li>• Do not retract properly</li> <li>• Restraining bar disconnects from restraining brackets when fully lowered</li> </ul>	Insufficient winding of the internal spring	Review the installation procedure and add extra tension. View video on YouTube for procedure.

## MANUAL OPERATION IN CASE OF POWER FAILURE

### **WARNING**

**RISK OF INJURY**  
DISCONNECT OR TURN OFF ALL POWER SUPPLY BEFORE STARTING  
INTERVENTION ON THE COVANA OPERATOR.

1. Disconnect or turn power off.
2. Unscrew and remove the four screws at the bottom of the operator and take cover off.
3. Use a 1/2" or 13 mm hexagon socket wrench to operate the operator by turning the input shaft.

**SLOWLY TURN THE SHAFT - STOP IF EXCESS TENSION IS FELT.  
NEVER USE A POWER TOOL AS THIS WILL DAMAGE UNIT.**

4. Turn the input shaft clockwise to lower the roof and counterclockwise to raise the roof.
5. Reinstall the operator cover.
6. Reconnect or turn on power.

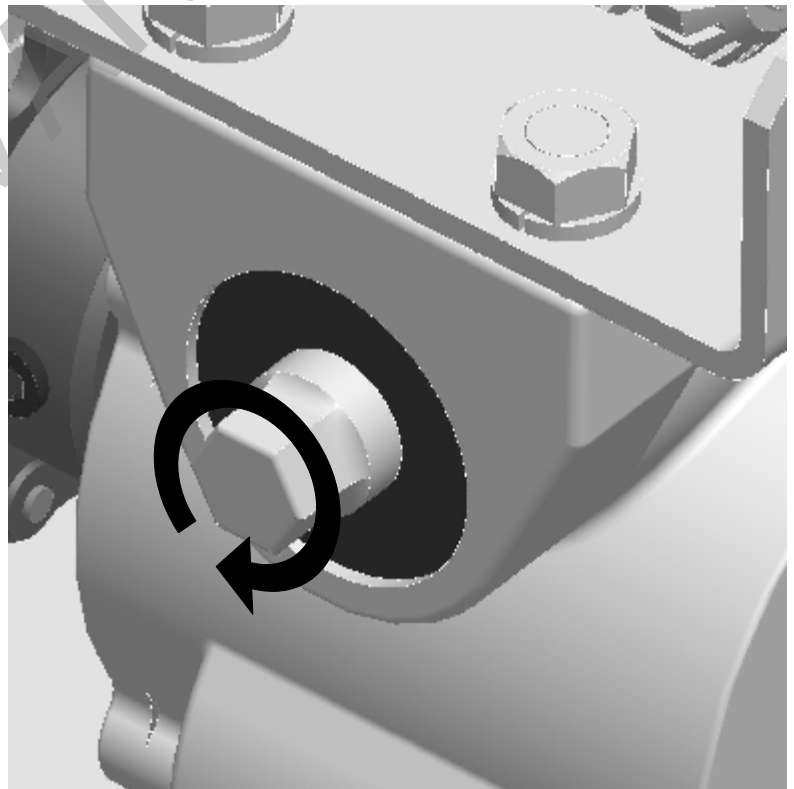
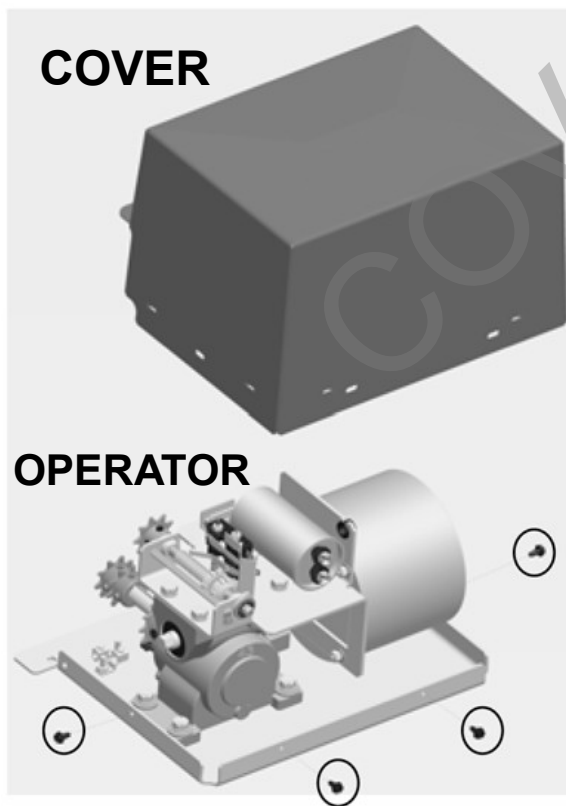

## SAFETY

### **WARNING**

#### **AVOID DROWNING RISK – ENTRAPMENT POSSIBLE**

FAILURE TO FOLLOW ALL INSTRUCTIONS MAY RESULT IN INJURY OR DROWNING  
INSPECT COVER PERIODICALLY — POWER SAFETY COVER MEETING ASTM F1346-91 REQUIREMENTS

- Never operate the Covana until all persons and objects are out of the spa.
- The Covana should only be operated by an adult.
- Always remove key after use, never leave the key in the key switch.
- Do not operate the Covana while in tub.
- The Covana should be in full view when operating the key switch.
- Never leave the Covana partially opened or partially closed.
- Lower the Covana in extreme wind conditions.
- Objects inside the spa cannot be seen when the Covana is closed.
- Supervise children at all times.
- Inspect roof for premature wear.
- Never allow persons or objects on the roof.

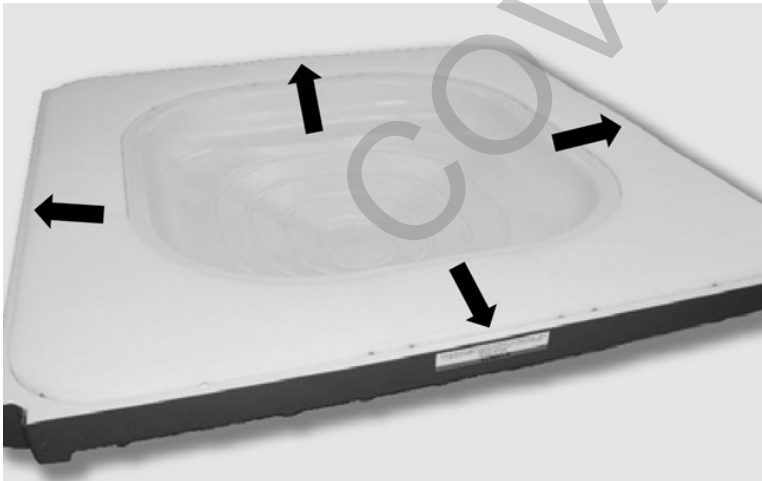

Labels on all four (4) exterior sides of the roof.

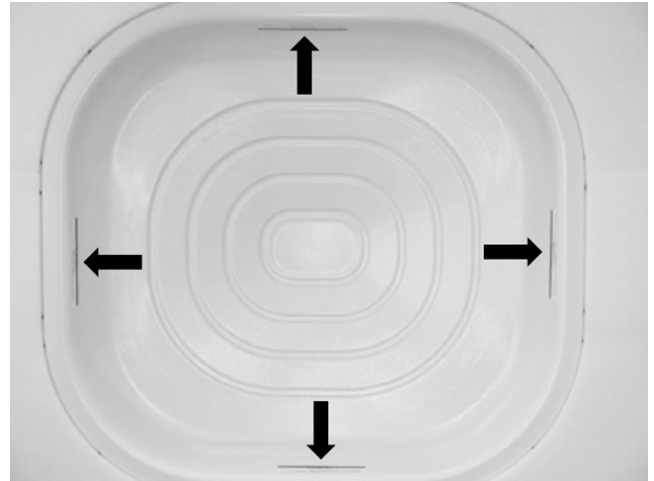

Labels on all four (4) interior sides of the roof.

If the original labels are damaged or no longer meet legibility requirements for safe viewing distance, please obtain replacement labels by contacting Covana or your retailer.



# COVANA LIGHTING OPTION

## Operating Procedures

Press the light switch, located in one of the four corners of the inner shell, to turn the lights on. The Covana lights operate in four modes which are changed by turning the lights off and then immediately back on.

### Four Modes:

1. **Fading:** Cycles through the seven colors, fading out one color and fading back in with a new color.
2. **Color Locked:** Color of choice is locked.
3. **Rotating:** Each color is cycled on and off for a few seconds.
4. **Flashing:** White light flashes quickly, on and off.

In the off position, the lights will reset after 10 seconds and will restart in the fading cycle.

## Maintenance

1. Ensure solar panel is clean and free of snow.
2. Always turn lights off - if left on, battery will need 2 to 3 sunny days to fully recharge.



## OASIS Consumer Limited Warranty 2015

This Limited Warranty is extended solely to the original purchaser of the OASIS "Automated Privacy Gazebo" purchased after January 1<sup>st</sup>, 2015 and installed for residential recreational use only. The warranty shall commence upon the original date of purchase for the OASIS.

### WHAT'S COVERED?

- 5 Years Structure** - The aluminum frame, brackets and telescoping sleeves are warranted against fracture, deformation and fatigue, due to defects in materials and workmanship for five (5) years from original date of purchase.
- 3 Years Shell** - The ABS inner and outer shell is warranted against cracking due to manufacturing defect for three (3) years from original date of purchase. Fading/weathering of surface and surface abrasions will occur naturally over time and are not considered defects. Improper spa water chemistry and misuse of spa chemicals may cause discoloration of the inner shell. Inner shell discoloration is not considered a defect and is not covered under this warranty.
- 3 Years Powder Coat Paint Finish** – The powder paint on all surfaces is warranted against chipping and peeling for three (3) years from original date of purchase. Fading/weathering of surface and surface abrasions will occur naturally over time and are not considered defects. Chipping of power paint on hardware may occur during assembly and servicing of the OASIS. These chips are not covered under this warranty.
- 3 Years Mechanical** – The mechanical components including; the motor, chains, drive shafts and jacks are warranted against malfunctions due to defects in materials or workmanship for three (3) years from original date of purchase.
- 2 Years Electrical** – The electrical components including; cables, electrical wires, and key switch controller are warranted against malfunctions due to defects in materials or workmanship for two (2) years from original date of purchase.
- 1 Year LED Light Assembly** –The optional LED light system (when applicable), as well as the solar panel are warranted against malfunctions due to defects in materials or workmanship for one (1) year from original date of purchase.
- Warranties for Other Components** – All other components not mentioned, including but not limited to, the batteries, the custom seal and accessories, are to be free of defects in materials and workmanship at the time of delivery and installation.

### WARRANTIES FOR THE OASIS SERIES

The warranty for the OASIS Series covers parts and labor for the first twelve (12) months after purchase. After twelve (12) months the warranty continues to cover 100% of part replacement until the end of terms described within this Limited Warranty. Canimex Inc. will not cover charges related to the removal of the defective part and installation of the new one, as well as travel expenses. Canimex Inc. will cover the cost of shipping of parts for the first 90 days from the date of sale. Contact your dealer for details regarding any such charges.

### PERFORMANCE

To obtain service in the event of a defect covered by this Limited Warranty, notify your Covana dealer as soon as possible and use all reasonable means to protect the Covana from further damage. Upon proof of purchase, a designated service representative will correct the defect subject to the terms and conditions contained in this Limited Warranty. Providing access to affect the repair is the responsibility of the Covana owner. In the event that the Covana is removed to a repair facility for repair and reinstalled, the cost of removal and reinstallation will be the responsibility of the Covana owner. Any replacement shall retain the remaining portion of the original warranty. In the event that you are unable to obtain service from you dealer please contact Covana Customer Service Department 1-877-278-8010 or via email at [service@covana.com](mailto:service@covana.com).

### WARRANTY LIMITATIONS

This Limited Warranty is void if; (i) Canimex Inc. or its agent determines that the OASIS has been subject to alteration, neglect, misuse, abuse or improper adjustment or installation of the equipment, (ii) used with equipment not covered in this warranty, (iii) installed or relocated to the extent that problems are attributable to the installation or relocation, (iv) located on any support surface other than that recommended in the installation manual; and/or (v) failure caused by accident, Acts of God or other causes beyond the control of Canimex Inc. Covana's in commercial use are excluded from any coverage whatsoever. The Covana owner accepts liability for repair work performed by anyone other than the designated Covana dealer.

### LIMITATIONS

This Limited Warranty takes the place of all other warranties either expressed or implied. All warranty work must be performed by an authorized agent or Canimex Inc. Customer may not dismantle the Covana and any attempt to dismantle systems other than describe herein, constitutes a modification or alteration of the Covana which may void the applicable warranty. No party, other than Canimex Inc. is authorized to alter this Limited Warranty in any way. Failure to install the Covana on the proper foundation as per the installation manual will void the warranty. Warranty is void if the Covana has been used in a non-residential application or in an application for which it was not designed for.

### DISCLAIMERS AND LEGAL RIGHTS

This Limited Warranty gives you specific legal rights. You may also have other rights that vary depending on country, state or province. The liability of Canimex Inc. under this limited warranty, if any, shall not exceed the original amount paid for the defective product. Prompt return of a completed warranty registration (by mail or e-mail) protects your warranty rights.



**Contact your dealer for all related service issues.**

Made in Canada  
by Canimex  
[www.covana.dk](http://www.covana.dk)

**Hydro-tech ApS**

Kastanievej 3  
2791 Dragør  
Danmark

(45) 3250 8281  
[covana@covana.dk](mailto:covana@covana.dk)